

# Accessories

## Bath Lighting

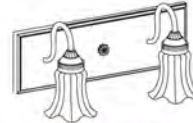

Traditional Lights (TSL)  
Available sizes w/ 1 light:  
Width: 6  
Height: 11



Traditional Lights (TL)  
Available sizes w/ 2 lights:  
Width: 17  
Height: 5 1/2



Traditional Lights (TL)  
Available sizes w/ 3, 4 and 5 lights:  
Width: 24, 30, 36, 48  
Height: 7

## wine and cup holders and pot racks



Wire Stem Glass Holder  
WSGH•PB (Polished Brass)  
WSGH•SC (Satin Chrome)  
WSGH•W (White)  
Available sizes:  
Width: 3 1/4  
Depth: 11 1/4



Stem Glass Holder (SCH)  
5, 7, 8 sections  
Available sizes:  
Width: 24, 30, 36  
Depth: 12



Wine Shelf (WS)  
4, 5 and 6 Bottle Capacity  
Available sizes:  
Width: 24, 30, 36  
Depth: 12  
Height: 3 1/4

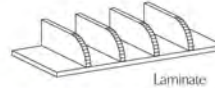

Wine Shelf (WS) 3 and 4 bottle capacity  
Available sizes:  
Width: 15, 18, 24  
Depth: 12  
Height: 3 1/4

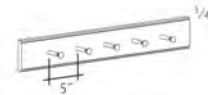

Cup Holder (CH)  
Available sizes in 3, 4, 5, 6, 8 and 9 pegs:  
Width: 18, 24, 30, 36, 42, 48  
Thickness: 1/4  
Height: 4 1/2

# Accessories

## cabinet features & kits

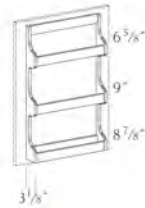

Spice Rack Kit (SRK)  
Fits cabinet sizes:  
Width: 15, 18, 21



Tiered Storage Shelf (TSS)  
Fits cabinet sizes:  
Width: 15, 18, 21  
Depth: 12



Knife Section (KS)  
Knife Section Kit (KSK)  
Fits cabinet sizes:  
Width: 15, 18, 21, 24  
Depth: 24

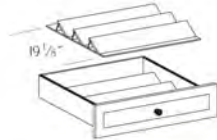

Spice Drawer Insert (SDI)  
Spice Drawer Insert Kit (SDIK)  
Fits cabinet sizes:  
Width: 12, 15, 18, 21, 24  
Depth: 24

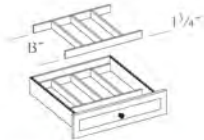

Cutlery Divider (CD)  
Cutlery Divider Kit (CDK)  
Fits cabinet sizes:  
Width: 12, 15, 18, 21, 24,  
27, 30, 33, 36  
Depth: 24



Wood Tiered Drawer Storage or Kit (WTCD)  
Fits cabinet sizes:  
Width: 15, 18, 21, 24  
Depth: 24

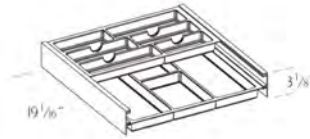

Tiered Cutlery Divider (TCD) Tiered Cutlery Divider Kit (TCDK)  
Fits cabinet sizes:  
Width: 15, 18, 21, 24  
Depth: 24



Cutting Center (CC) Cutting Center Kit (CCK)  
Fits cabinet sizes:  
Width: 15, 18, 21, 24  
Depth: 24

# Accessories (continued)

**KraftMaid**  
Cabinetry

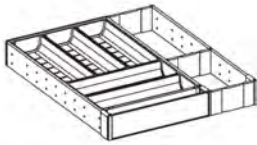

Stainless Cutlery Divider (SCDK)  
Fits cabinet sizes:  
Width: 21, 24, 27  
Depth: 24



Knife Section Cutting Center (KSCC)  
Knife Section Cutting Center Kit (KSCCK)  
Fits cabinet sizes:  
Width: 15, 18, 21, 24  
Depth: 24

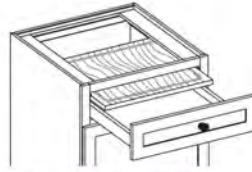

Chopping Block (CHB)  
Chopping Block Kit (CHBK)  
Fits cabinet sizes:  
Width: 18, 21, 24  
Depth: 24

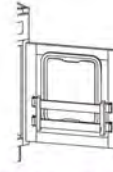

Cutting Board Door Rack Kit (CBDMK)  
Fits cabinet sizes:  
Width: 18, 21, 24



Sink Base Door Storage Unit or Kit (SBDUSU)  
Fits cabinet sizes:  
Width: 30, 33, 36, 39, 42

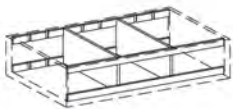

Adjustable Drawer Dividers (ADD)  
Fits cabinet sizes:  
Width: 24, 27, 30, 33, 36



Drawer Partition (DP)  
Fits drawer sizes:  
Height: 4.7, 11



Tray Dividers (TD)  
Available sizes:  
Depth: 24  
Thickness: 1/8 or 1/4

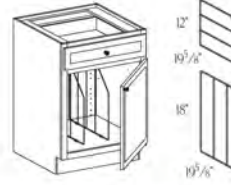

Wire Tray Dividers (WTDK)  
Available sizes:  
Height: 12, 18  
Depth: 19 1/4



Roll-out Shelf (ROSTK)  
Fits cabinet sizes:  
Width: 12, 15, 16, 18, 19, 21, 22, 24, 27



Roll-out Tray (ROT)  
Fits cabinet sizes:  
Width: 12, 15, 16, 18, 19, 21, 22, 24, 27, 30, 33, 36  
Depth: 18, 21, 24



Deep Roll-out Tray (DROT)  
Fits cabinet sizes:  
Width: 12, 15, 16, 18, 19, 21, 22, 24, 27, 30, 33, 36  
Depth: 18, 21, 24

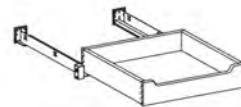

Deluxe Roll-Out Tray (DXROT)  
Available sizes:  
Width: 12, 15, 18, 21, 24, 27, 30, 33, 36  
Depth: 18, 21, 24



High Back Roll-out Tray (HBROT)  
Available sizes:  
Width: 12, 15, 16, 18, 19, 21, 22, 24, 27, 30, 33, 36  
Depth: 18, 21, 24



CD Roll-out Tray (CDROT)  
Available sizes:  
Width: 15, 18, 21, 24  
Depth: 18, 21, 24



DVD Roll-out Tray (DVDROT)  
Available sizes:  
Width: 15, 18, 21, 24  
Depth: 18, 21, 24



CD/DVD Roll-out Tray (CDDVDROT)  
Available sizes:  
Width: 15, 18, 21, 24  
Depth: 18, 21, 24



Roll-out Tray Divided Kit Field Installation (ROTDK)  
Fits cabinet sizes:  
Width: 12, 15, 16, 18, 19, 21, 22, 24, 27, 30, 33, 36  
Depth: 18, 21, 24

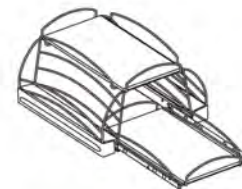

Base Cookware Storage Roll-out (BCSRK)  
Fits cabinet sizes:  
Width: 24  
Depth: 24



Base Pots and Pans Organizer Roll-out (BPPSO)  
Fits cabinet sizes:  
Width: 30, 36  
Depth: 24

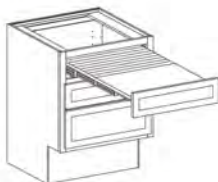

Pull Out Table Kit (POTK)  
Fits cabinet sizes:  
Depth: 24  
Width: 24



Bread Box (BB) Bread Box Kit (BBK)  
Fits deep drawer of cabinet sizes:  
Width: 15, 18, 21, 24

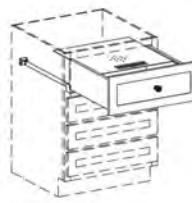

Sliding Bread Box Lid (SBB)  
Fits deep drawer of cabinet sizes:  
Width: 15, 18, 21, 24

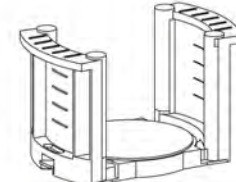
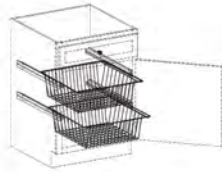

Plate Caddy (PTC)  
Fits drawer sizes:  
Height: 7, 11

# Accessories (continued)

## Cabinet Features & Kits



Vegetable Bin Kit (VBK)  
Fits cabinet sizes:  
Width: 15, 18, 24



Ironing Board Kit (IBK)  
Fits cabinet sizes:  
Width: 18

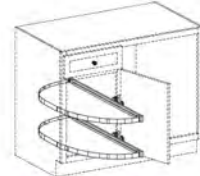

Lazy Susan Kit (LSK,  
LSK•WLS)  
Fits blind cabinet sizes:  
Width: 42, 45, 48



Sliding Towel Bar (STB)  
Available sizes:  
Width: 4  
Depth: 17 1/4



Utensil Tray or Kit (UTK)  
Fits cabinet sizes:  
Width: 18, 21, 24, 27, 30, 33,  
39, 42, 45, 48

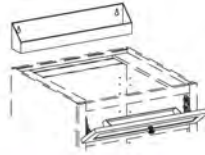

Stainless Utensil Tray or Kit (SUTK)  
Fits cabinet sizes:  
Width: 18, 21, 24, 27, 30, 33,  
39, 42, 45, 48

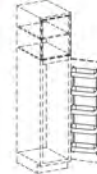

Door Storage Kit (DSK)  
For use with utility cabinet sizes:  
Width: 18 (5-13 1/4 wide shelves)  
Width: 24 (10-7 1/4 wide shelves)

## Shelves, Spindles, Corbels and Countertop Supports



Spindles (SP)  
Available sizes:  
Thickness: 2, 2 1/2, 2 3/4  
Height: 24, 30, 36, 42, 48



Spindles (SP)  
Available sizes:  
Thickness: 4 1/4  
Height: 36, 42



Split Spindles (SP\_•S)  
Available sizes:  
Thickness: 2, 2 1/2, 2 3/4  
Height: 24, 30, 36, 42, 48



Roman Spindles (RSP)  
Available sizes:  
Thickness: 4 1/4  
Height: 36, 42



Tapered Leg (TPL)  
Available sizes:  
Thickness: 2 1/2  
Height: 6



Classic Leg (CL)  
Available sizes:  
Thickness: 2 1/4  
Height: 34 1/4, 42



Rope Leg (RL)  
Available sizes:  
Thickness: 2 1/4  
Height: 34 1/4, 42

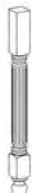

Fluted Leg (FL)  
Available sizes:  
Thickness: 2 1/4  
Height: 34 1/4, 42

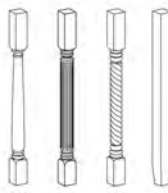

Decorative Posts  
(CL, FL, RP, TPL)  
Available sizes:  
Thickness: 2 1/2  
Height: 34 1/4, 42



Fluted Square Posts (FSP)  
Available sizes:  
Thickness: 2 5/8, 6  
Height: 30, 34 1/2, 36, 42



Plain Square Posts (PSP)  
Available sizes:  
Thickness: 2 5/8, 6  
Height: 30, 34 1/2, 36, 42



Aluminum Leg Square (ASL)  
Round (ARL)  
Available sizes:  
Thickness: 1 5/8  
Height: 4, 28, 34 1/2, 40



Stainless Round Leg (SRL)  
Available sizes:  
Thickness: 1 5/8  
Height: 4, 28, 34 1/2, 40



Under Cabinet Shelf (UCS)  
Available sizes:  
Width: 12, 15, 18, 21, 24, 27,  
30, 33, 36  
Shelf Depth: 3 1/4  
Height: 8 1/2



Under Cabinet Shelf-Scalloped  
(UCS\_•S)  
Available sizes:  
Width: 12, 15, 18, 21, 24, 27,  
30, 33, 36  
Shelf Depth: 2 1/4  
Height: 8 1/2



Under Cabinet Shelf-Victorian  
(UCS\_•V)  
Available sizes:  
Width: 12, 15, 18, 21, 24, 27,  
30, 33, 36  
Shelf Depth: 2 1/4  
Height: 8 1/2



Under Cabinet Shelf (UCS)  
Available sizes:  
Width: 12, 15, 18, 21, 24, 27,  
30, 33, 36  
Shelf Depth: 4 1/4  
Height: 18

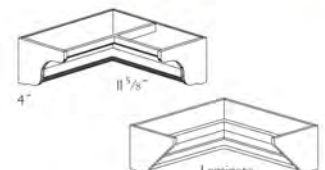

Under Cabinet Shelf Corner  
(UCSC)  
Available sizes:  
Width: 21, 24, 27  
Height: 8 1/2

# Accessories (continued)

**KraftMaid**  
Cabinetry



Under Cabinet Shelf  
Corner-  
Scalloped (UCSC\_●S)  
Available sizes:  
Width: 21, 24, 27  
Height: 8 1/2

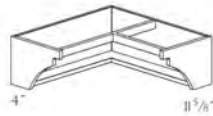

Under Cabinet Shelf Corner-  
Victorian (UCSC\_●V)  
Available sizes:  
Width: 21, 24, 27  
Height: 8 1/2

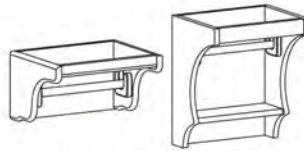

Paper Towel Holder (PTH)  
Available sizes:  
Width: 15  
Height: 8 1/8, 18



Acanthus Corbel (AC)  
Available sizes:  
Width: 2 1/4, 5 1/2, 5 3/4  
Depth: 2 1/2, 6 1/8, 9 1/8  
Height: 9, 13, 13 1/2



Braid Corbel (BRC)  
Available sizes:  
Width: 2 1/4, 5 1/2, 5 3/4  
Depth: 2 1/2, 3, 3 3/4, 4  
Height: 6, 9, 13, 13 1/2

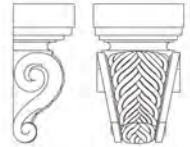

Cove Corbel (CVC)  
Available sizes:  
Width: 4 1/2  
Depth: 4  
Height: 6

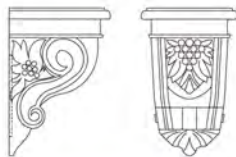

Grape Corbel (GC)  
Available sizes:  
Width: 2 1/4, 5 1/2, 5 3/4  
Depth: 2 1/2, 6 1/8, 9 1/8  
Height: 8 1/4, 12 1/4, 13 1/2



Olive Leaf Corbel (OLC)  
Available sizes:  
Width: 2 1/4, 5 1/2, 5 3/4  
Depth: 2 1/2, 2 3/4, 3 1/2, 4  
Height: 6, 9, 13, 13 1/2



Rosette Corbel (RC)  
Available sizes:  
Width: 3 1/4, 5 1/2, 5 3/4  
Depth: 2 1/2, 6 1/8, 9 1/8  
Height: 9, 13, 13 1/2



Woven Corbel (WNC)  
Available sizes:  
Width: 2 1/4, 5 1/2, 5 3/4  
Depth: 2 1/2, 2 3/4, 3 1/2, 4  
Height: 6, 9, 13, 13 1/2



Shelf Support Bracket  
Scalloped (SSB●S)  
Available sizes:  
Width: 1 1/4  
Depth: 5  
Height: 5 1/2



Shelf Support Bracket  
Victorian (SSB●V)  
Available sizes:  
Width: 1 1/4  
Depth: 5  
Height: 5 1/2



Countertop Support (CTS)  
Available sizes:  
Width: 3  
Depth: 11 1/4  
Height: 11 1/4



Countertop Support  
(CTS) White and Ivory  
Available sizes:  
Width: 3  
Depth: 11 1/8  
Height: 9 1/8



Countertop Support  
(CTS●S) Scalloped  
Available sizes:  
Width: 3  
Depth: 11 1/4  
Height: 11 1/4



Countertop Support  
(CTS●V) Victorian  
Available sizes:  
Width: 3  
Depth: 11 1/4  
Height: 11 1/4



Countertop Support  
(CTS●VP) Victorian Plain  
Available sizes:  
Width: 3  
Depth: 11 1/4  
Height: 11 1/4

See your kitchen design specialist about KraftMaid Cabinetry's complete selection of moldings, options and accessories.

Note: The following condensed cabinet specifications are provided to familiarize you with the options and sizes available from KraftMaid. Once you've chosen some of the features you would like in your kitchen, bath or other room, please see your kitchen and bath design specialist to help bring those ideas to life.

Note: Depths listed are for cabinet box. Add door thickness for total depth.

Specifications subject to change without notice.

Note: 12", 15" and 18" high wall cabinets receive no shelves, 24" and 27" high include 1 adjustable shelf, 30" high includes 2 adjustable shelves, and 36" and 42" high include 3 adjustable shelves.

FOR SINGLE-DOOR CABINETS, SPECIFY RIGHT OR LEFT HINGE.

(Sizes shown in inches)